

SECTION D, HARDWARE AND INSULATION MATERIAL, 3000 SERIES

FIGURE NUMBER	DESCRIPTION	PAGES
FIG. 003003	10-32 PAN HEAD MACHINE SCREW.....	D-1
FIG. 003004	12-24 PAN HEAD MACHINE SCREW.....	D-2
FIG. 003005	1/4-20 ROUND HEAD MACHINE SCREW, STEEL	D-2
FIG. 003006	1/4-20 HEXAGON HEAD CAP SCREW, STEEL	D-3
FIG. 003007	1/4-20 FLAT HEAD MACHINE SCREW, STEEL.....	D-3
FIG. 003008	5/16-18 HEX HEAD CAP SCREW, STEEL	D-4
FIG. 003009	5/16-18 FLAT HEAD MACHINE SCREW, STEEL.....	D-5
FIG. 003010	3/8-16 HEXAGON HEAD CAP SCREW, STEEL.....	D-5
FIG. 003011	1/2-13 HEXAGON HEAD CAP SCREW, STEEL.....	D-6
FIG. 003012	5/8-11 HEXAGON HEAD CAP SCREW, STEEL.....	D-7
FIG. 003013	3/8 LAG SCREW.....	D-7
FIG. 003014	HEAVY HEXAGON NUT.....	D-8
FIG. 003015	HELICAL SPRING LOCK WASHER.....	D-8
FIG. 003016	FLAT WASHER.....	D-9
FIG. 003017	3/8-16 CONNECTOR BOLT.....	D-9
FIG. 003018	MACHINE BOLT EXPANSION SHIELD.....	D-10
FIG. 003019	LAG SCREW EXPANSION SHIELD.....	D-10
FIG. 003020	THREADED ROD, 3/8-16.....	D-11
FIG. 003021	THREADED ROD, 1/2-13.....	D-11
FIG. 003022	THREADED ROD, 5/8-11.....	D-11
FIG. 003023	THREADED STUD, 3/8-16.....	D-11

SECTION D, HARDWARE AND INSULATION MATERIAL, 3000 SERIES

FIGURE NUMBER	DESCRIPTION	PAGES
FIG. 212600	RIGID PVC CHANNEL STRIP.....	D-12
FIG. 211012	SPLIT TUBING, 3/4" D.....	D-12
FIG. 003024	MISCELLANEOUS J-BOLTS.....	D-13
FIG. 003025	MISCELLANEOUS V-BOLTS.....	D-13
FIG. 003026	SPANNER J-BOLT.....	D-14
FIG. 003027	CLIP J-BOLT.....	D-14
FIG. 003028	MISCELLANEOUS J-BOLT AND V-BOLT PLATES.....	D-15
FIG. 003029	CABLE RACK SIDE BAR HANGER BRACKET.....	D-15
FIG. 003030	SLOTTED TYPE HANGING BRACKET.....	D-16
FIG. 003031	PARALLEL AUXILIARY FRAMING CLIP.....	D-16
FIG. 003032	PARALLEL AUXILIARY FRAMING CLIP FOR CROSSOVER JUNCTION.....	D-17
FIG. 003033	WALL ANGLE DRILLED, 2" X 2" X 1/4" ANGLE IRON.....	D-17
FIG. 003034	AUXILIARY FRAMING ANGLE, 2" X 2" X 3/16" ANGLE IRON...	D-18
FIG. 003035	AUXILIARY FRAMING ANGLE, 3" X 3" X 1/4" ANGLE IRON.....	D-18
FIG. 003037	1" STANDARD PIPE.....	D-19
FIG. 003038	MAIN FRAME END CLIP, VERTICAL SIDE.....	D-19
FIG. 003039	MAIN FRAME END CLIP, HORIZONTAL SIDE.....	D-20
FIG. 003041	CABLE BRACKET	D-20
FIG. 003042	CABLE DISTRIBUTION RINGS.....	D-21
FIG. 003043	U-BOLT.....	D-21

SECTION D, HARDWARE AND INSULATION MATERIAL, 3000 SERIES

FIGURE NUMBER	DESCRIPTION	PAGES
FIG. 003044	U-BOLT SQUARE BEND.....	D-22
FIG. 003045	MISCELLANEOUS U-BOLT PLATES.....	D-22
FIG. 003047	LADDER TRACK.....	D-23
FIG. 003048	LADDER BRACKET.....	D-23
FIG. 003049	LADDER TRACK STOP.....	D-24
FIG. 003050	LADDER TRACK SPLICE.....	D-24
FIG. 003052	PVC PIPE FOR COVERING 5/8" DIA THREADED ROD.....	D-25
FIG. 003053	THREADED ROD COUPLING.....	D-25
FIG. 003054	TOUCH-UP PAINT, AEROSOL.....	D-26
FIG. 004356	TOUCH UP PAINT.....	D-26
FIG. 003069	NYLON ROUND HEAD SCREW (TYPE 6/6).....	D-27
FIG. 003070	NYLON HEX HEAD CAP SCREW (TYPE 6/6).....	D-28
FIG. 003071	NYLON HEX NUT (TYPE 6/6).....	D-28
FIG. 003072	NYLON FLAT WASHER (TYPE 6/6).....	D-29
FIG. 003074	BEAM CLAMP.....	D-30
FIG. 003075	NYLON/STEEL CORE PAN HEAD SCREW.....	D-30
FIG. 003076	TOGGLE BOLT ASSEMBLY.....	D-31
FIG. 210894	12-24 THREAD FORMING SCREW.....	D-31
FIG. 208017	EXTERNAL TOOTH LOCK WASHER.....	D-32
FIG. 211581	J-BOLT KIT.....	D-32

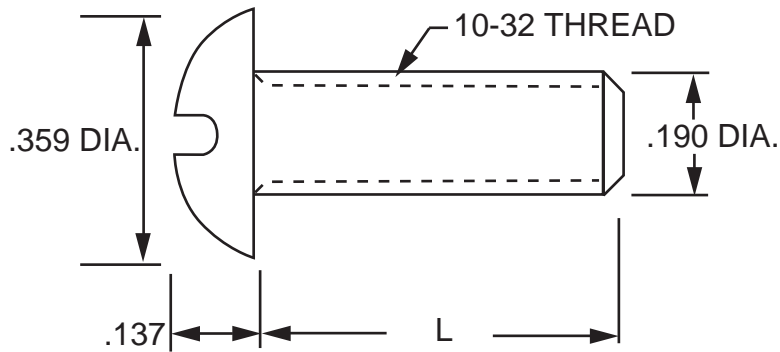

ORDERING TABLE

ORDERING NO.	L	T	PACKAGED QTY.	ORDERING NO.	L	T	PACKAGED QTY.
0030030110	1/4	1/4	100	0030031010	1-1/8	1-1/8	100
0030030210	5/16	5/16	100	0030031110	1-1/4	1-1/4	100
0030030310	3/8	3/8	100	0030031210	1-1/2	1-1/2	100
0030030410	7/16	7/16	100	0030034310	1-3/4	1-3/4	100
0030030510	1/2	1/2	100	0030031410	2	2	100
0030030610	5/8	5/8	100	0030031510	2-1/4	1-3/4	100
0030030710	3/4	3/4	100	0030031610	2-1/2	1-3/4	50
0030030810	7/8	7/8	100	0030031710	2-3/4	1-3/4	50
0030030910	1	1	100	0030031810	3	1-3/4	25

NOTES:

1. FINISH IS ZINC PLATED AND GOLD CHROMATE.
2. DIMENSIONS ARE NOMINAL.
3. HARDWARE IS GRADE 5.
4. THREAD LENGTH (T) SHOWN IS MINIMUM ON SCREWS NOT FULLY THREADED.
5. AVAILABLE ONLY IN MULTIPLES OF PACKAGED QUANTITY SHOWN.

ORDERING NUMBER: REFER TO TABLE

10-32 ROUND HEAD MACHINE SCREW, STEEL

FIG. 003003

NOTES:

1. STANDARD FINISH IS STAINLESS STEEL.
2. AVAILABLE ONLY IN MULTIPLES OF PACKAGED QUANTITY SHOWN.

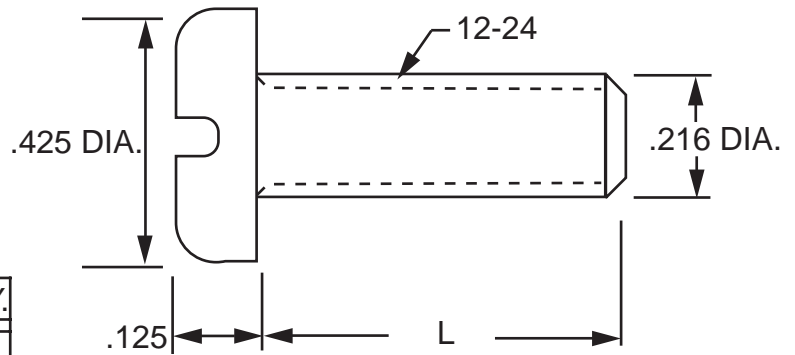

ORDERING TABLE

ORDERING NO.	L	PACKAGED QTY.
0030040112	3/8	100
0030040212	7/16	100
0030040312	1/2	100
0030040412	5/8	100
0030040512	3/4	100
0030040612	1	100
2023810712	1/4	100
2023810812	5/16	100
2023810912	3/16	100

ORDERING NUMBER: REFER TO TABLE

FIG. 003004

12-24 PAN HEAD MACHINE SCREW

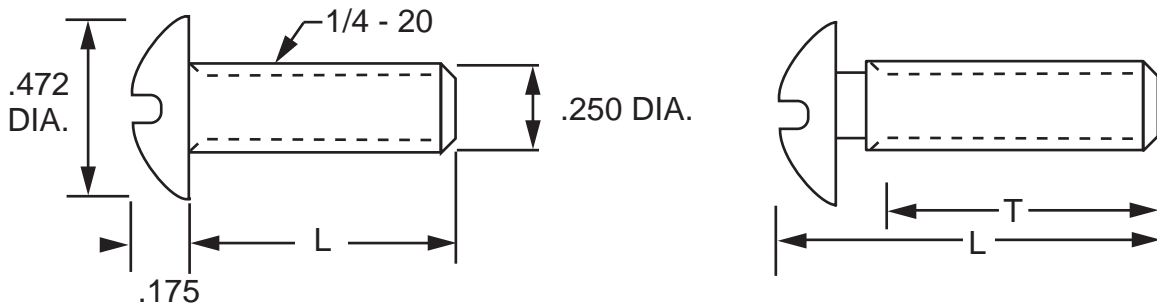

ORDERING TABLE

ORDERING NO.	L	T	PKGD. QTY.	ORDERING NO.	L	T	PKGD. QTY.
0030050110	5/16	5/16	100	0030050910	1-1/4	1-1/4	100
0030050210	3/8	3/8	100	0030051010	1-1/2	1-1/2	100
0030050310	1/2	1/2	100	0030051110	1-3/4	1-3/4	100
0030050410	5/8	5/8	100	0030051210	2	2	100
0030050510	3/4	3/4	100	0030051310	1-1/4	1-3/4	50
0030050610	7/8	7/8	100	0030051410	2-1/2	1-3/4	50
0030050710	1	1	100	0030051510	2-3/4	1-3/4	50
0030050810	1-1/8	1-1/8	100	0030051610	3	3	25

NOTES:

1. FINISH IS ZINC PLATED AND GOLD CHROMATE.
2. THREAD LENGTH (T) SHOWN IS MINIMUM ON SCREWS NOT FULLY THREADED.
3. AVAILABLE ONLY IN MULTIPLES OF PACKAGED QUANTITY SHOWN.

ORDERING NUMBER: REFER TO TABLE

FIG. 003005

1/4-20 ROUND HEAD MACHINE SCREW, STEEL

NEWTON INSTRUMENT COMPANY, INC.

Butner, NC

NOTES:

1. FINISH IS ZINC PLATED AND GOLD CHROMATE.
2. DIMENSIONS ARE NOMINAL.
3. HARDWARE IS GRADE 5.
4. THREAD LENGTH (T) SHOWN IS MINIMUM ON SCREWS NOT FULLY THREADED.
5. AVAILABLE ONLY IN MULTIPLES OF PACKAGED QUANTITY SHOWN.

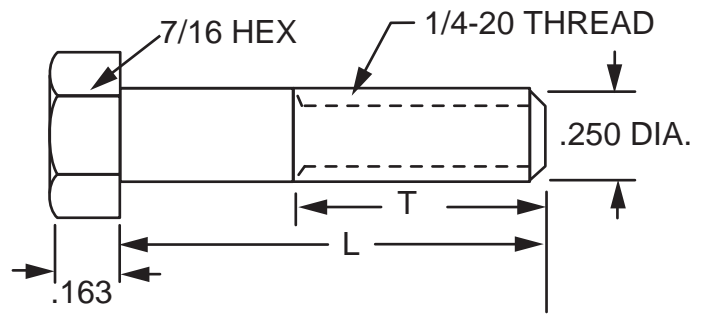

ORDERING TABLE

ORDERING NO.	L	T	PACKAGED QTY.	ORDERING NO.	L	T	PACKAGED QTY.
0030060110	1/2	1/2	100	0030061210	2-3/4	3/4	50
0030060210	5/8	5/8	100	0030061310	3	3/4	50
0030060310	3/4	3/4	100	0030061410	3-1/4	3/4	25
0030060410	7/8	3/4	100	0030061510	3-1/2	3/4	25
0030060510	1	3/4	100	0030061610	3-3/4	3/4	25
0030060610	1-1/4	3/4	100	0030061710	4	3/4	25
0030060710	1-1/2	3/4	100	0030061810	4-1/2	3/4	10
0030060810	1-3/4	3/4	100	0030061910	5	3/4	10
0030060910	2	3/4	100	0030062010	5-1/2	3/4	10
0030061010	2-1/4	3/4	100	0030062110	6	3/4	10
0030061110	2-1/2	3/4	100				

ORDERING NUMBER: REFER TO TABLE

1/4-20 HEXAGON HEAD CAP SCREW, STEEL

FIG. 003006

ORDERING TABLE

ORDERING NO.	L	T	PKGD. QTY.	ORDERING NO.	L	T	PKGD. QTY.
0030070110	7/16	7/16	100	0030070910	1-1/2	1-1/2	100
0030070210	1/2	1/2	100	0030071010	1-3/4	1-3/4	100
0030070310	5/8	5/8	100	0030071110	2	2	100
0030070410	3/4	3/4	100	0030071210	2-1/4	1-3/4	50
0030070510	7/8	7/8	100	0030071310	2-1/2	1-3/4	50
0030070610	1	1	100	0030071410	2-3/4	1-3/4	25
0030070710	1-1/8	1-1/8	100	0030071510	3	1-3/4	25
0030070810	1-1/4	1-1/4	100				

NOTES:

1. FINISH IS ZINC PLATED AND GOLD CHROMATE.
2. DIMENSIONS ARE NOMINAL.
3. HARDWARE IS GRADE 5.
4. THREAD LENGTH (T) SHOWN IS MINIMUM ON SCREWS NOT FULLY THREADED. 80° TO 82° COUNTERSINK.
5. AVAILABLE ONLY IN MULTIPLES OF PACKAGED QUANTITY SHOWN.

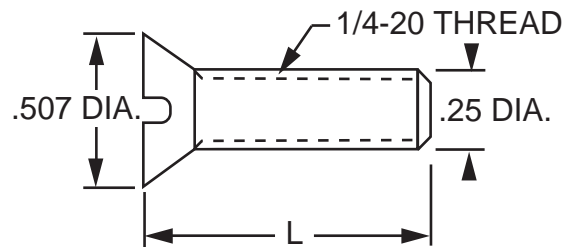

ORDERING NUMBER: REFER TO TABLE

1/4-20 FLAT HEAD MACHINE SCREW, STEEL

FIG. 003007

NEWTON INSTRUMENT COMPANY, INC.

R2

Butner, NC

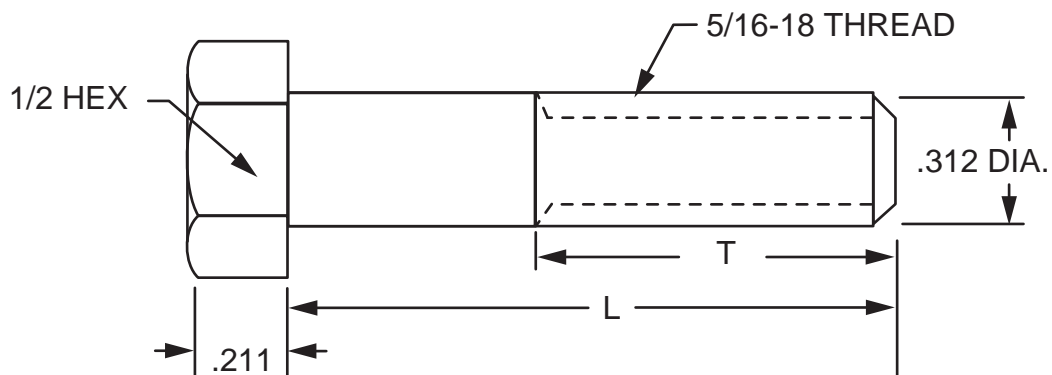

ORDERING TABLE

ORDERING NO.	L	T	PACKAGED QTY.	ORDERING NO.	L	T	PACKAGED QTY.
0030080110	1/2	1/2	100	0030081210	2-3/4	7/8	50
0030080210	5/8	5/8	100	0030081310	3	7/8	25
0030080310	3/4	3/4	100	0030081410	3-1/4	7/8	25
0030080410	7/8	7/8	100	0030081510	3-1/2	7/8	25
0030080510	1	7/8	100	0030081610	3-3/4	7/8	25
0030080610	1-1/4	7/8	100	0030081710	4	7/8	10
0030080710	1-1/2	7/8	100	0030081810	4-1/2	7/8	10
0030080810	1-3/4	7/8	100	0030081910	5	7/8	10
0030080910	2	7/8	100	0030082010	5-1/2	7/8	10
0030081010	2-1/4	7/8	50	0030082110	6	7/8	10
0030081110	2-1/2	7/8	50				

NOTES:

1. FINISH IS ZINC PLATED AND GOLD CHROMATE.
2. DIMENSIONS ARE NOMINAL.
3. HARDWARE IS GRADE 5.
4. THREAD LENGTH (T) SHOWN IS MINIMUM ON SCREWS NOT FULLY THREADED.
5. AVAILABLE ONLY IN MULTIPLES OF PACKAGED QUANTITY SHOWN.

ORDERING NUMBER: REFER TO TABLE

5/16-18 HEX HEAD CAP SCREW, STEEL

FIG. 003008

NOTES:

1. FINISH IS ZINC PLATED AND GOLD CHROMATE.
2. DIMENSIONS ARE NOMINAL.
3. HARDWARE IS GRADE 5.
4. THREAD LENGTH (T) SHOWN IS MINIMUM ON SCREWS NOT FULLY THREADED. 80° TO 82° COUNTERSINK.
5. AVAILABLE ONLY IN MULTIPLES OF PACKAGED QUANTITY SHOWN.

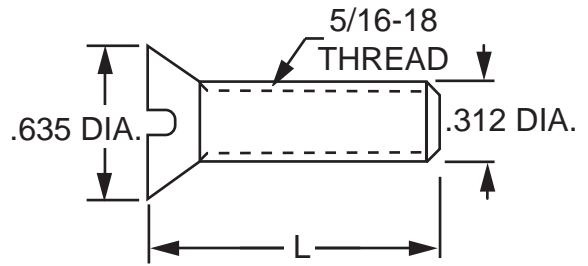

ORDERING TABLE

ORDERING NO.	L	T	PACKAGED QTY.	ORDERING NO.	L	T	PACKAGED QTY.
0030090110	1/2	1/2	100	0030090710	1-1/2	1-1/2	100
0030090210	5/8	5/8	100	0030090810	1-3/4	1-3/4	100
0030090310	3/4	3/4	100	0030090910	2	2	100
0030090410	7/8	7/8	100	0030091010	2-1/2	1-3/4	50
0030090510	1	1	100	0030091110	3	1-3/4	25
0030090610	1-1/4	1-1/4	100				

ORDERING NUMBER: REFER TO TABLE

5/16-18 FLAT HEAD MACHINE SCREW, STEEL

FIG. 003009

NOTES:

1. FINISH IS ZINC PLATED AND GOLD CHROMATE.
2. DIMENSIONS ARE NOMINAL.
3. HARDWARE IS GRADE 5.
4. THREAD LENGTH (T) SHOWN IS MINIMUM ON SCREWS NOT FULLY THREADED.
5. AVAILABLE ONLY IN MULTIPLES OF PACKAGED QUANTITY SHOWN.

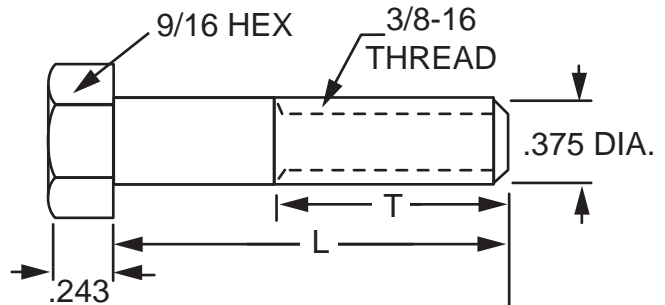

ORDERING TABLE

ORDERING NO.	L	T	PACKAGED QTY.	ORDERING NO.	L	T	PACKAGED QTY.
0030100110	1/2	1/2	100	0030101210	2-3/4	1	50
0030100210	5/8	5/8	100	0030101310	3	1	25
0030100310	3/4	3/4	100	0030101410	3-1/4	1	25
0030100410	7/8	7/8	100	0030101510	3-1/2	1	25
0030100510	1	1	100	0030101610	3-3/4	1	25
0030100610	1-1/4	1	100	0030101710	4	1	10
0030100710	1-1/2	1	100	0030101810	4-1/2	1	10
0030100810	1-3/4	1	100	0030101910	5	1	10
0030100910	2	1	100	0030102010	5-1/2	1	10
0030101010	2-1/4	1	50	0030102110	6	1	10
0030101110	2-1/2	1	50				

ORDERING NUMBER: REFER TO TABLE

3/8-16 HEXAGON HEAD CAP SCREW, STEEL

FIG. 003010

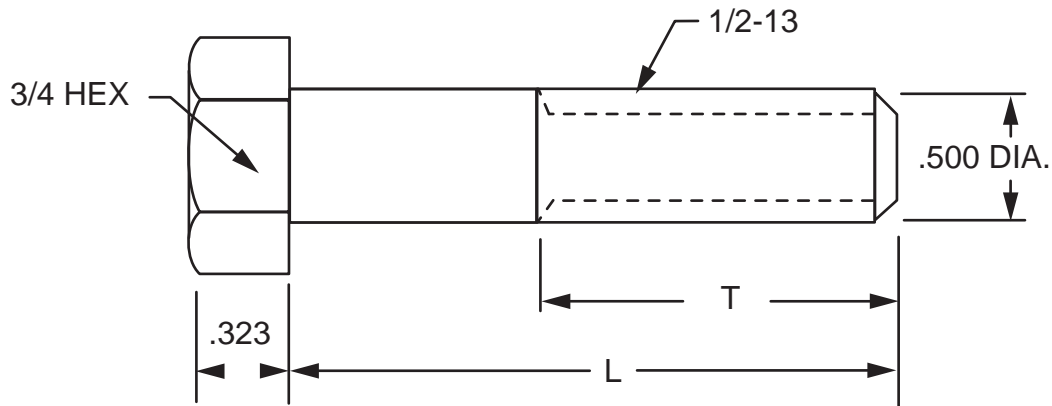

NOTES:

1. FINISH IS ZINC PLATED AND GOLD CHROMATE.
2. DIMENSIONS ARE NOMINAL.
3. HARDWARE IS GRADE 5.
4. THREAD LENGTH (T) SHOWN IS MINIMUM ON SCREWS NOT FULLY THREADED.
5. AVAILABLE ONLY IN MULTIPLES OF PACKAGED QUANTITY SHOWN.

ORDERING TABLE

ORDERING NO.	L	T	PKGD. QTY.	ORDERING NO.	L	T	PKGD. QTY.
0030110110	3/4	3/4	50	0030111110	3	1-1/4	25
0030110210	7/8	7/8	50	0030111210	3-1/4	1-1/4	25
0030110310	1	1	50	0030111310	3-1/2	1-1/4	25
0030110410	1-1/4	1-1/4	50	0030111410	3-3/4	1-1/4	25
0030110510	1-1/2	1-1/4	50	0030111510	4	1-1/4	10
0030110610	1-3/4	1-1/4	50	0030111610	4-1/2	1-1/4	10
0030110710	2	1-1/4	50	0030111710	5	1-1/4	10
0030110810	2-1/4	1-1/4	50	0030111810	5-1/2	1-1/4	10
0030110910	2-1/2	1-1/4	50	0030111910	6	1-1/4	10
0030111010	2-3/4	1-1/4	50				

ORDERING NUMBER: REFER TO TABLE

1/2-13 HEXAGON HEAD CAP SCREW, STEEL

FIG. 003011

NOTES:

1. FINISH IS ZINC PLATED AND GOLD CHROMATE.
2. DIMENSIONS ARE NOMINAL.
3. HARDWARE IS GRADE 5.
4. THREAD LENGTH (T) SHOWN IS MINIMUM ON SCREWS NOT FULLY THREADED.
5. AVAILABLE ONLY IN MULTIPLES OF PACKAGED QUANTITY SHOWN.

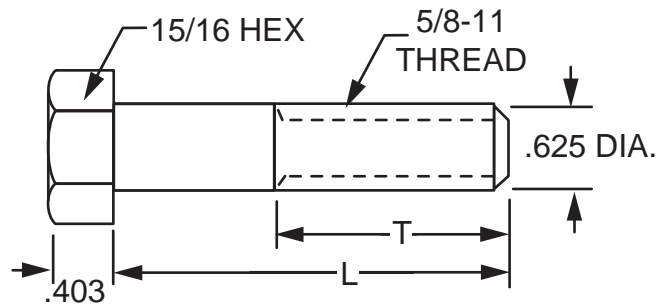

ORDERING TABLE

ORDERING NO.	L	T	PACKAGED QTY.	ORDERING NO.	L	T	PACKAGED QTY.
0030120110	1	1	25	0030121110	3-1/2	1-1/4	25
0030120210	1-1/4	1-1/4	25	0030121210	3-3/4	1-1/4	25
0030120310	1-1/2	1-1/2	25	0030121310	4	1-1/4	10
0030120410	1-3/4	1-1/2	25	0030121410	4-1/2	1-1/4	10
0030120510	2	1-1/2	25	0030121510	5	1-1/4	10
0030120610	2-1/4	1-1/4	25	0030121610	5-1/2	1-1/4	10
0030120710	2-1/2	1-1/4	25	0030121710	6	1-1/4	10
0030120810	2-3/4	1-1/4	25	0030121810	6-1/2	1-3/4	10
0030120910	3	1-1/4	25	0030121910	7	1-3/4	10
0030121010	3-1/4	1-1/4	25				

ORDERING NUMBER: REFER TO TABLE

5/8-11 HEXAGON HEAD CAP SCREW, STEEL

FIG. 003012

NOTES:

1. FINISH IS ZINC PLATED AND GOLD CHROMATE.
2. AVAILABLE ONLY IN MULTIPLES OF PACKAGED QUANTITY SHOWN.

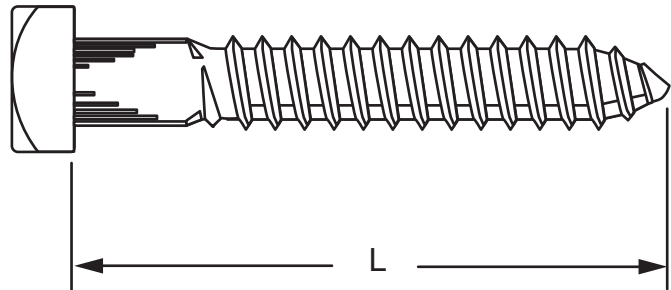
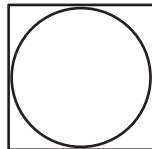

ORDERING TABLE

ORDERING NO.	L	PACKAGED QTY.	ORDERING NO.	L	PACKAGED QTY.
0030130110	1	100	0030130510	2	100
0030130210	1-1/4	100	0030130610	2-1/2	50
0030130310	1-1/2	100	0030130710	3	25
0030130410	1-3/4	100			

ORDERING NUMBER: REFER TO TABLE

3/8 LAG SCREW

FIG. 003013

ORDERING TABLE

ORDERING NO.	THREAD	L	T	PKGD. QTY.	ORDERING NO.	THREAD	L	T	PKGD. QTY.
0030140110	8-32	11/32	.130	100	0030140510	5/16-18	9/16	.330	100
0030140210	10-32	3/8	.130	100	0030140610	3/8-16	11/16	.393	100
0030140310	12-24	7/16	.161	100	0030140710	1/2-13	7/8	.520	50
0030140410	1/4-20	1/2	.266	100	0030140810	5/8-11	1-1/16	.647	50

NOTES:

1. FINISH IS ZINC PLATED AND GOLD CHROMATE.
2. DIMENSIONS ARE NOMINAL.
3. HARDWARE IS GRADE 5 (3/8 OR LARGER).
4. AVAILABLE ONLY IN MULTIPLES OF PACKAGED QUANTITY SHOWN.

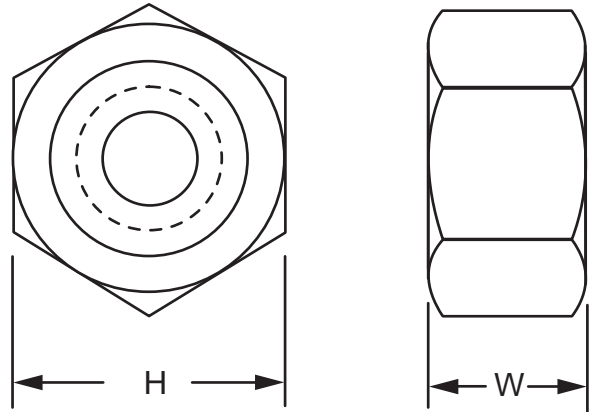

ORDERING NUMBER: REFER TO TABLE

HEAVY HEXAGON NUT

FIG. 003014

ORDERING TABLE

ORDERING NO.	SIZE	ID	OD	W	T	PACKAGED QTY.
0030150110	NO. 8	.168	.296	.055	.040	100
0030150210	NO. 10	.194	.337	.062	.047	100
0030150310	NO. 12	.221	.380	.070	.056	100
0030150410	1/4	.225	.493	.109	.062	100
0030150510	5/16	.319	.591	.125	.087	100
0030150610	3/8	.382	.688	.141	.094	100
0030150710	1/2	.509	.879	.171	.125	50
0030150810	5/8	.636	1.086	.203	.156	50

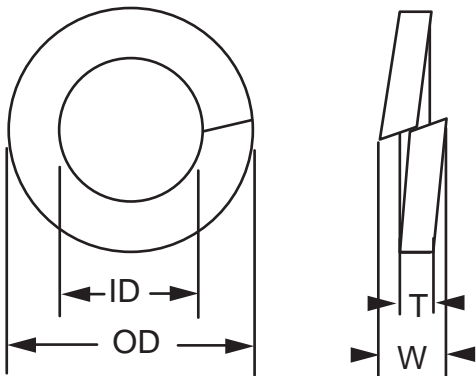

NOTES:

1. FINISH IS ZINC PLATED AND GOLD CHROMATE.
2. DIMENSIONS ARE NOMINAL.
3. HARDWARE IS GRADE 5.
4. AVAILABLE ONLY IN MULTIPLES OF PACKAGED QUANTITY SHOWN.

ORDERING NUMBER: REFER TO TABLE

HELICAL SPRING LOCK WASHER

FIG. 003015

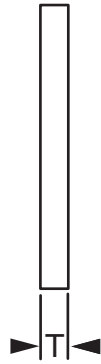
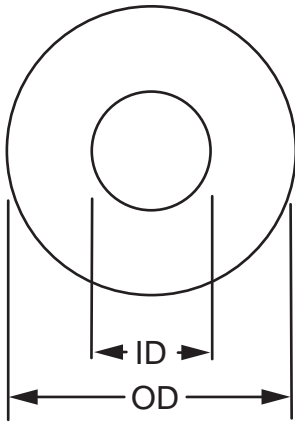

NOTES:

1. FINISH IS ZINC PLATED AND GOLD CHROMATE.
2. DIMENSIONS ARE NOMINAL.
3. AVAILABLE ONLY IN MULTIPLES OF PACKAGED QUANTITY SHOWN.

ORDERING TABLE

ORDERING NO.	SIZE	ID	OD	T	PACKAGED QTY.
0030160110	NO. 8	.188	1/2	.045	100
0030160210	NO. 10	.208	9/16	.045	100
0030160310	NO. 12	.240	5/8	.071	100
0030160410	1/4	.281	49/64	.071	100
0030160510	5/16	.344	7/8	.071	100
0030160610	3/8	.406	1	.071	100
0030160710	1/2	.540	1-1/4	.112	50
0030160810	5/8	.666	1-3/4	.112	50
0030160910	3/4	.812	2	.112	50

ORDERING NUMBER: REFER TO TABLE

FLAT WASHER

FIG. 003016

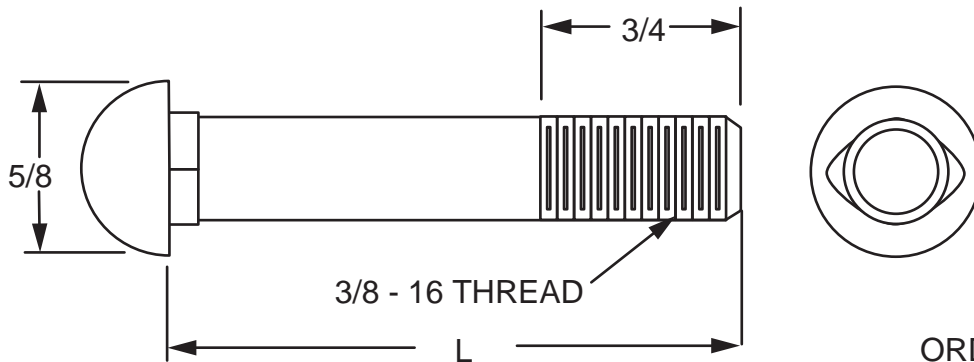

ORDERING TABLE

ORDERING NO.	SIZE	PACKAGED QTY.
0030170110	1-3/8	100
0030170210	2-1/8	50
0030170310	2-3/4	50
0030170410	2-3/8	50
0030170510	3	25
0030170610	2	100

NOTES:

1. FINISH IS ZINC PLATED AND GOLD CHROMATE.
2. DIMENSIONS ARE NOMINAL.
3. AVAILABLE ONLY IN MULTIPLES OF PACKAGED QUANTITY SHOWN.

ORDERING NUMBER: REFER TO TABLE

3/8-16 CONNECTOR BOLT

FIG. 003017

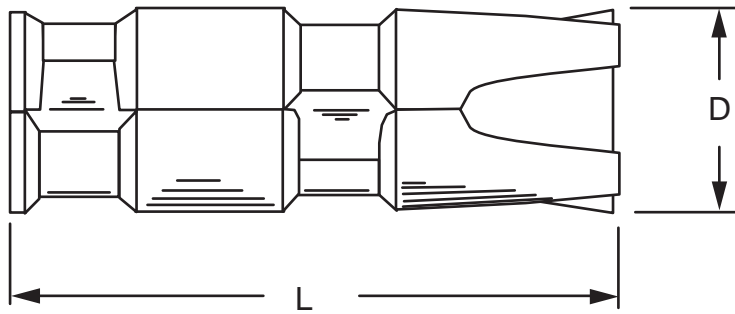

ORDERING TABLE

ORDERING NO.	SIZE	L	D	PACKAGED QTY.
0030180100	1/4	1-1/4	1/2	100
0030180200	5/16	2	5/8	100
0030180300	5/16	1-1/2	5/8	50
0030180500	3/8	1-1/2	5/8	50
0030180800	1/2	2	7/8	25
0030181000	5/8	2-1/2	1	25

NOTES:

1. DIMENSIONS ARE NOMINAL.
2. AVAILABLE ONLY IN MULTIPLES OF PACKAGED QUANTITY SHOWN.

ORDERING NUMBER: REFER TO TABLE

MACHINE BOLT EXPANSION SHIELD

FIG. 003018

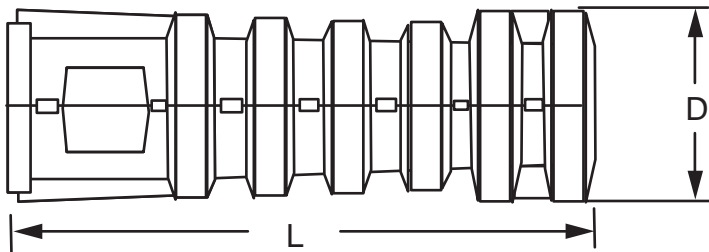

ORDERING TABLE

ORDERING NO.	SIZE	L	D	PACKAGED QTY.
0030190100	1/4	1-1/2	1/2	100
0030190200	1/4	1	1/2	100
0030190300	5/16	1-3/4	1/2	100
0030190400	5/16	1-1/4	1/2	100
0030190500	3/8	2-1/2	5/8	50
0030190600	3/8	1-3/4	5/8	50
0030190700	1/2	3	3/4	25
0030190800	1/2	2	3/4	25
0030190900	5/8	3-1/2	7/8	25
0030191000	5/8	2	7/8	25

NOTES:

1. DIMENSIONS ARE NOMINAL.
2. AVAILABLE ONLY IN MULTIPLES OF PACKAGED QUANTITY SHOWN.

ORDERING NUMBER: REFER TO TABLE

LAG SCREW EXPANSION SHIELD

FIG. 003019

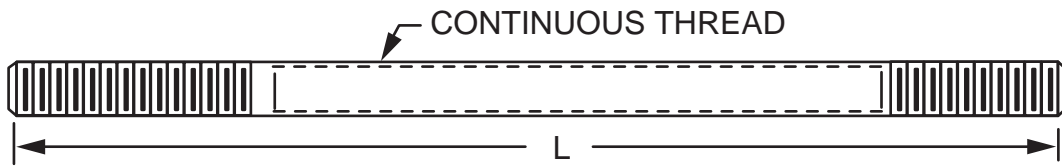

3/8-16 ORDERING TABLE

ORDERING NO.	L	ORDERING NO.	L
0030200110	6	0030200710	42
0030200210	12	0030200810	48
0030200310	18	0030200910	54
0030200410	24	0030201010	60
0030200510	30	0030201110	72
0030200610	36		

1/2-13 ORDERING TABLE

ORDERING NO.	L	ORDERING NO.	L
0030210110	6	0030210710	42
0030210210	12	0030210810	48
0030210310	18	0030210910	54
0030210410	24	0030211010	60
0030210510	30	0030211110	72
0030210610	36		

5/8-11 ORDERING TABLE

ORDERING NO.	L	ORDERING NO.	L
0030220110	6	0030220710	42
0030220210	12	0030220810	48
0030220310	18	0030220910	54
0030220410	24	0030221010	60
0030220510	30	0030221110	72
0030220610	36		

3/8-16 STUD ORDERING TABLE

ORDERING NO.	L	ORDERING NO.	L
0030230110	2-1/2	0030230510	3-1/2
0030230210	2-3/4	0030230610	3-3/4
0030230310	3	0030230710	4
0030230410	3-1/4		

NOTES:

1. FINISH IS ZINC PLATED AND GOLD CHROMATE.
2. DIMENSIONS ARE NOMINAL.
3. HARDWARE IS GRADE B7.

ORDERING NUMBER: REFER TO TABLE

FIG. 003020

FIG. 003021

FIG. 003022

FIG. 003023

THREADED ROD

NEWTON INSTRUMENT COMPANY, INC.

Butner, NC

ORDERING TABLE

ORDERING NO.	DIM A
2126000100	6'-9"
2126000200	7'-3"
2126000300	7'-9"
2126000400	8'-9"
2126000500	11'-6"

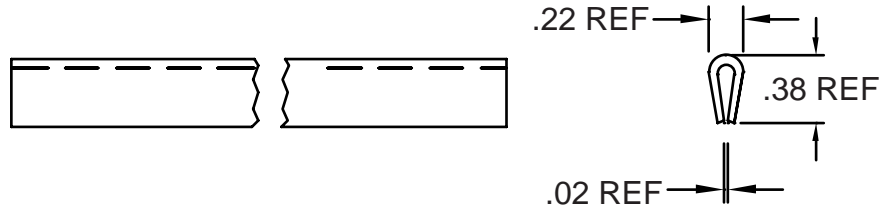

NOTES:

1. MEETS OR EXCEEDS UL FLAMMABILITY REQUIREMENT UL 94 V-1.

ORDERING NUMBER: REFER TO TABLE

RIGID PVC CHANNEL STRIP

FIG. 212600

ORDERING TABLE

ORDERING NO.	LENGTH
2110120100	72"
2110120200	120"

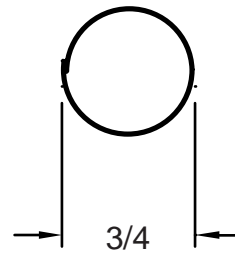
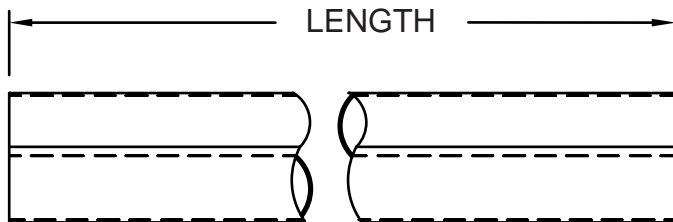

NOTES:

1. FOR USE ON 5/8" THREADED ROD (OR EQUIVALENT).
2. RATED UL 94 V-0.

ORDERING NUMBER: REFER TO TABLE

SPLIT TUBING, 3/4" D

FIG. 211012

NOTES:

1. FINISH IS ZINC PLATED AND GOLD CHROMATE.
2. DIMENSIONS ARE NOMINAL.
3. SPECIAL SIZES AVAILABLE UPON REQUEST.
4. AVAILABLE ONLY IN MULTIPLES OF PACKAGED QUANTITY SHOWN.

ORDERING TABLE

ORDERING NO.	L-1	W	L-2	T	THREAD	PKGD. QTY.
0030240110	1-3/4	1/4	1/2	3/4	1/4-20	100
0030240210	3-1/4	7/16	3/4	1-1/2	1/4-20	100
0030240310	2-1/4	7/16	3/4	1	1/4-20	50
0030240410	3-3/4	5/16	3/4	1-1/4	5/16-18	50
0030240510	3-1/4	7/16	3/4	3/4	5/16-18	50
0030240610	3-1/4	7/16	3/4	1-1/2	5/16-18	50
0030240710	2-1/4	7/16	3/4	1	5/16-18	50
0030240810	3-3/4	7/16	3/4	1-1/4	5/16-18	50
0030240910	2-3/4	7/16	3/4	1-1/4	5/16-18	50
0030241010	2-1/4	5/16	3/4	1	5/16-18	50
0030241110	2-3/4	5/16	3/4	1-1/4	5/16-18	50
0030241210	1-3/4	5/16	3/4	3/4	5/16-18	50

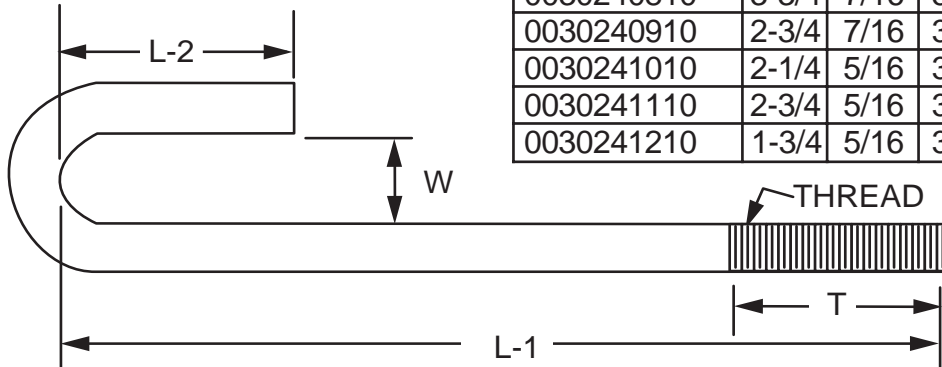

ORDERING NUMBER: REFER TO TABLE

MISCELLANEOUS J-BOLTS

FIG. 003024

ORDERING TABLE

ORDERING NO.	L	T	W	THREAD	PKGD. QTY.
0030250110	3	1	2-7/16	3/8-16	25
0030250210	4	1-1/4	2-7/16	3/8-16	25
0030250310	6	1-1/2	2-7/16	3/8-16	25
0030250410	5	1-1/2	2-5/8	1/2-13	25
0030250510	8	2	2-5/8	1/2-13	25
0030250610	13	10-3/4	2-11/16	5/8-11	1

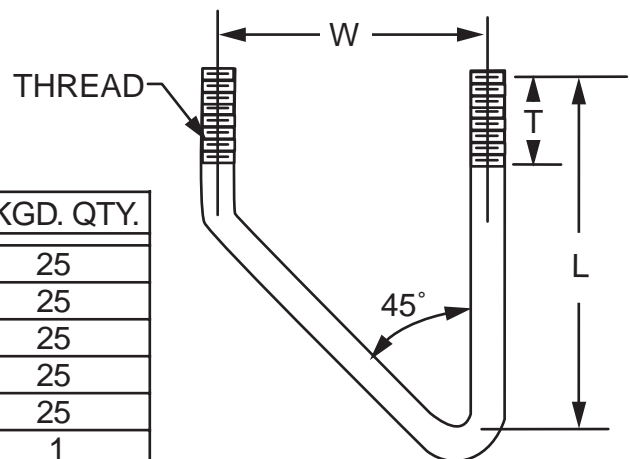

NOTES:

1. FINISH IS ZINC PLATED AND GOLD CHROMATE.
2. DIMENSIONS ARE NOMINAL.
3. AVAILABLE ONLY IN MULTIPLES OF PACKAGED QUANTITY SHOWN.

ORDERING NUMBER: REFER TO TABLE

MISCELLANEOUS V-BOLTS

FIG. 003025

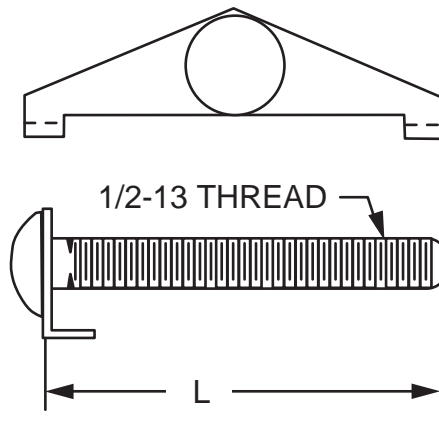

NOTES:

1. FINISH IS ZINC PLATED AND GOLD CHROMATE.
2. DIMENSIONS ARE NOMINAL.
3. SPECIAL SIZES AVAILABLE UPON REQUEST.
4. BOLT IS FULLY THREADED.

ORDERING TABLE

ORDERING NO.	L
0030260110	3-1/8
0030260210	3-3/8
0030260310	3-5/8
0030260410	4-3/8
0030260510	4-7/8

ORDERING NUMBER: REFER TO TABLE

SPANNER J-BOLT

FIG. 003026

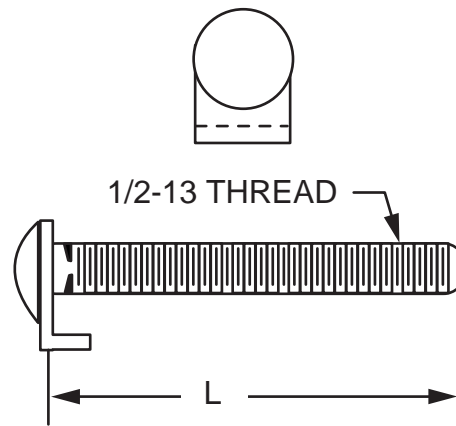

NOTES:

1. FINISH IS ZINC PLATED AND GOLD CHROMATE.
2. DIMENSIONS ARE NOMINAL.
3. BOLT IS FULLY THREADED.

ORDERING TABLE

ORDERING NO.	L
0030270110	3-1/8
0030270210	3-3/8
0030270310	3-5/8
0030270410	4-3/8
0030270510	4-7/8

ORDERING NUMBER: REFER TO TABLE

CLIP J-BOLT

FIG. 003027

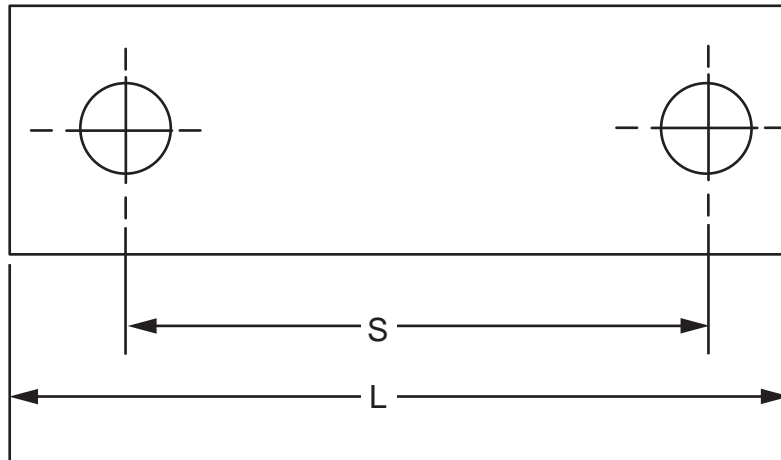

NOTES:

1. FINISH IS ZINC PLATED AND GOLD CHROMATE.
2. DIMENSIONS ARE NOMINAL.

ORDERING TABLE

ORDERING NO.	L	S	HOLE
0030280110	3-1/2	2-7/16	11/32
0030280210	3-1/2	2-7/16	7/16
0030280310	3-1/2	2-21/32	9/32
0030280410	3-3/4	2-11/16	11/16
0030280510	6.08	4.70	1/2

ORDERING NUMBER: REFER TO TABLE

MISCELLANEOUS J-BOLT AND V-BOLT PLATES

FIG. 003028

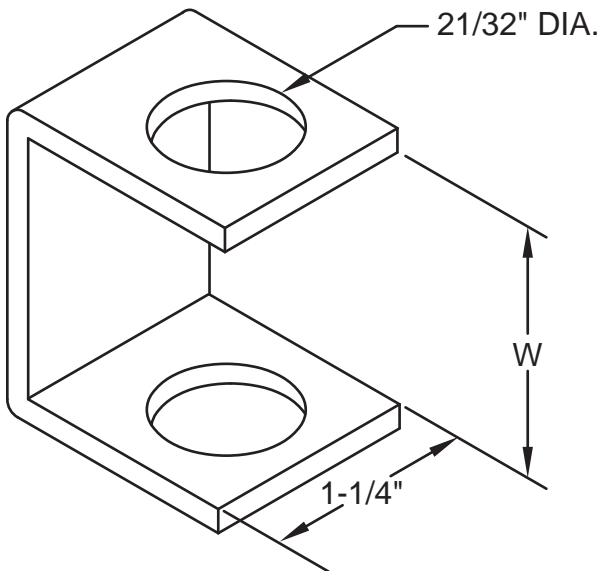

ORDERING TABLE

ORDERING NO.	W	THREADED ROD
2137680110	1-17/32	3/8
2137680210	2-1/32	3/8
2137680310	1-17/32	1/2
2137680410	2-1/32	1/2
0030290110	1-17/32	5/8
0030290210	2-1/32	5/8

NOTES:

1. FINISH IS ZINC PLATED AND GOLD CHROMATE.
2. DIMENSIONS ARE NOMINAL.

ORDERING NUMBER: REFER TO TABLE

CABLE RACK SIDE BAR HANGER BRACKET

FIG. 003029

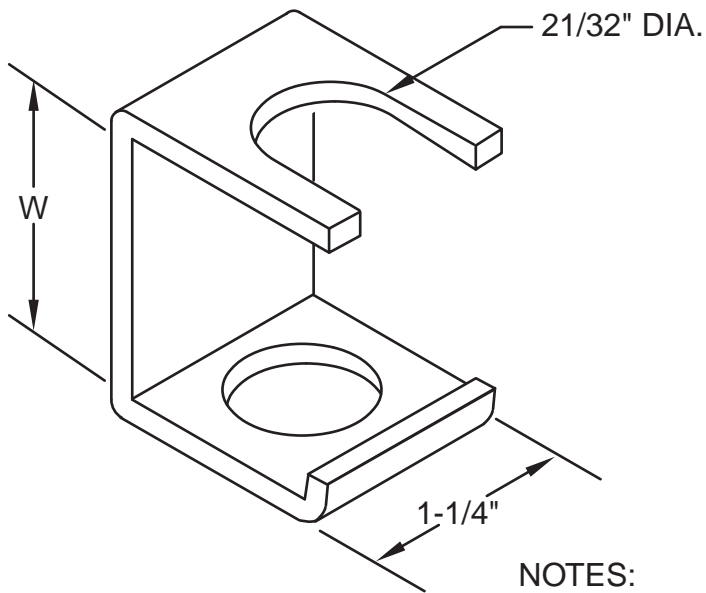

ORDERING TABLE

ORDERING NO.	W	THREADED ROD
2137610110	1-17/32	3/8
2137610210	1-17/32	1/2
2137610310	2-1/32	1/2
0030300110	1-17/32	5/8
0030300210	2-1/32	5/8

NOTES:

1. FINISH IS ZINC PLATED AND GOLD CHROMATE.
2. DIMENSIONS ARE NOMINAL.
3. SPECIAL SIZES AVAILABLE UPON REQUEST.

ORDERING NUMBER: REFER TO TABLE

SLOTTED TYPE HANGING BRACKET

FIG. 003030

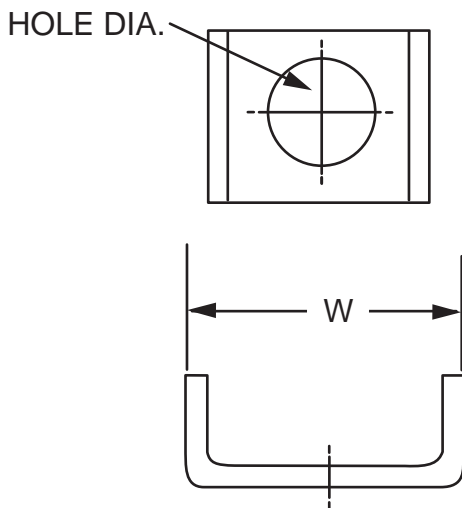

ORDERING TABLE

ORDERING NO.	W	HOLE
0030310110	1-1/2	13/32
0030310210	1-1/2	17/32
0030310310	1-1/2	21/32
0030310410	1-7/8	13/32
0030310510	1-7/8	17/32
0030310610	1-7/8	21/32
0030310710	2-11/16	17/32

NOTES:

1. FINISH IS ZINC PLATED AND GOLD CHROMATE.
2. DIMENSIONS ARE NOMINAL.

ORDERING NUMBER: REFER TO TABLE

PARALLEL AUXILIARY FRAMING CLIP

FIG. 003031

ORDERING TABLE

ORDERING NO.	W	HOLE
0030320110	1-1/2	13/32
0030320210	1-1/2	17/32
0030320310	1-1/2	21/32
0030320410	1-7/8	13/32
0030320510	1-7/8	17/32
0030320610	1-7/8	21/32

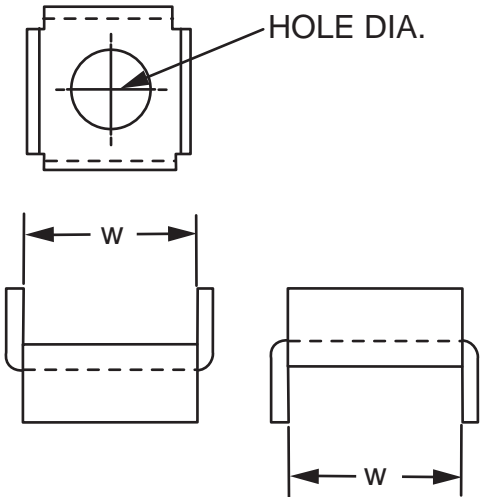

- NOTES:
1. FINISH IS ZINC PLATED AND GOLD CHROMATE.
 2. DIMENSIONS ARE NOMINAL.
 3. SPECIAL SIZES AVAILABLE UPON REQUEST.

PARALLEL AUXILIARY FRAMING CLIP
FOR CROSSOVER JUNCTION

ORDERING NUMBER: REFER TO TABLE
FIG. 003032

ORDERING TABLE

ITEM	ORDERING NO.
1	00303301XX
2	00303302XX
3	00303303XX
4	00303304XX
5	00303305XX
6	00303306XX

- NOTES:
1. XX = FINISH CODE; STANDARD FINISH, XX = 30.

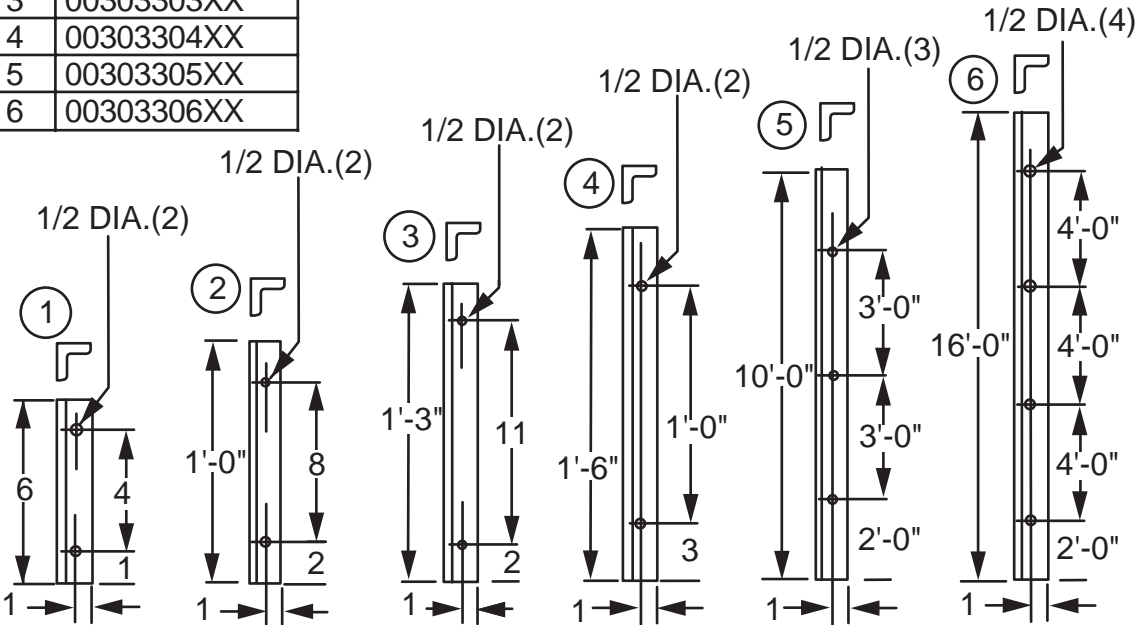

ORDERING NUMBER: REFER TO TABLE

WALL ANGLE DRILLED, 2" X 2" X 1/4" ANGLE IRON

FIG. 003033

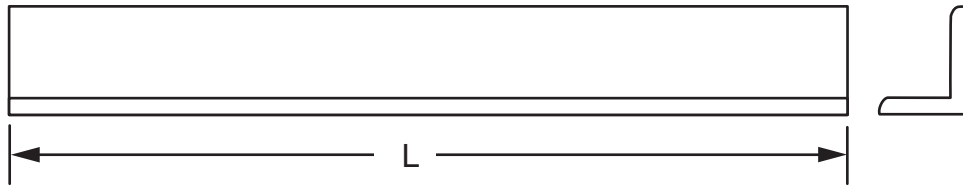

ORDERING TABLE

ORDERING NO.	L	ORDERING NO.	L
00303401XX	2'	00303406XX	12'
00303402XX	4'	00303407XX	14'
00303403XX	6'	00303408XX	16'
00303404XX	8'	00303409XX	18'
00303405XX	10'	00303410XX	20'

NOTES:

1. XX = FINISH CODE; STANDARD FINISH, XX = 30.

ORDERING NUMBER: REFER TO TABLE

AUXILIARY FRAMING ANGLE, 2" X 2" X 3/16" ANGLE IRON

FIG. 003034

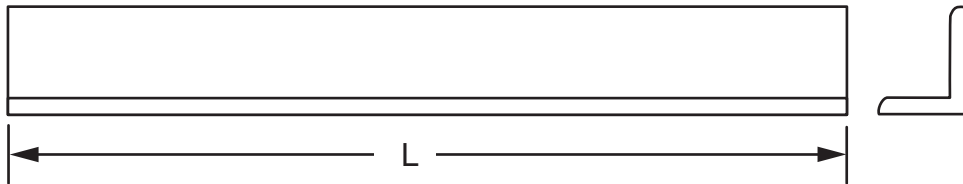

ORDERING TABLE

ORDERING NO.	L	ORDERING NO.	L
00303501XX	2'	00303506XX	12'
00303502XX	4'	00303507XX	14'
00303503XX	6'	00303508XX	16'
00303504XX	8'	00303509XX	18'
00303505XX	10'	00303510XX	20'

NOTES:

1. XX = FINISH CODE; STANDARD FINISH, XX = 30.

ORDERING NUMBER: REFER TO TABLE

AUXILIARY FRAMING ANGLE, 3" X 3" X 1/4" ANGLE IRON

FIG. 003035

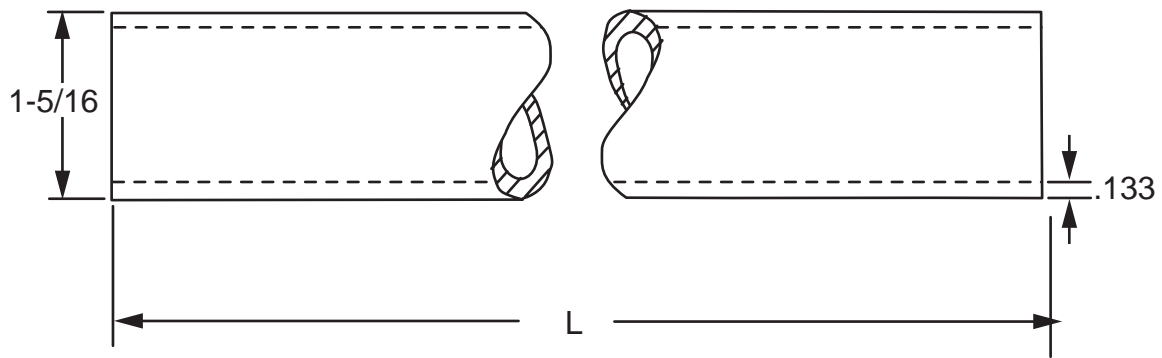

ORDERING TABLE

ORDERING NO.	L	ORDERING NO.	L
00303701XX	3-1/2"	00303704XX	6'
00303702XX	2'	00303705XX	8'
00303703XX	4'	00303706XX	10'

NOTES:

1. XX = FINISH CODE; STANDARD FINISH, XX = 30.
2. SCHEDULE 40 PIPE. DIMENSIONS ARE NOMINAL.

ORDERING NUMBER: REFER TO TABLE

STANDARD 1" PIPE

FIG. 003037

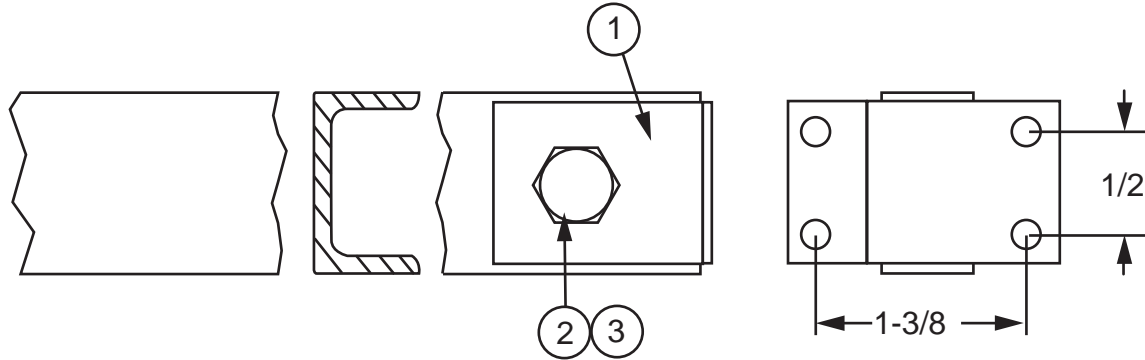

STOCK LIST

ITEM	QTY	DESCRIPTION
1	1	END CLIP
2	1	5/16-18 X 5/8" HHCS
3	1	5/16 NUT

NOTES:

1. XX = FINISH CODE; STANDARD FINISH, XX = 30.

ORDERING NUMBER: 00303800XX

MAIN FRAME END CLIP, VERTICAL SIDE

FIG. 003038

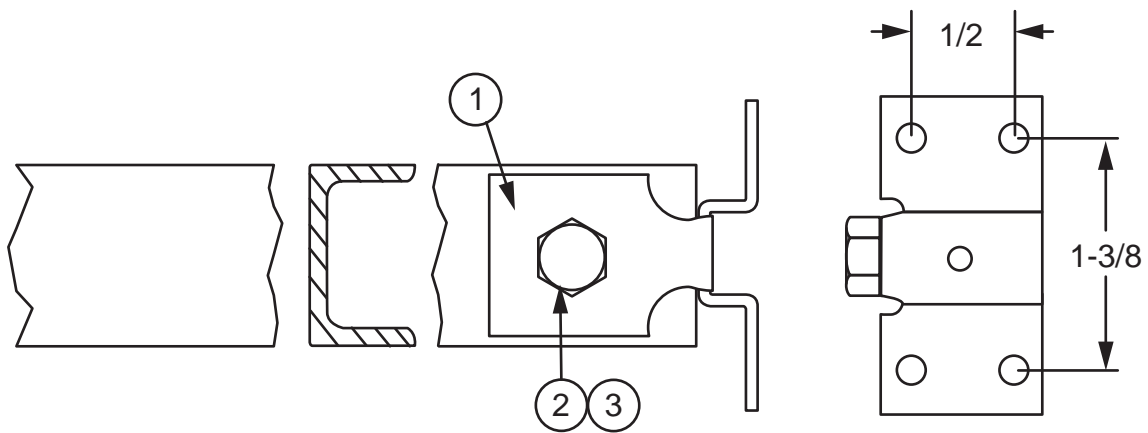

STOCK LIST

ITEM	QTY	DESCRIPTION
1	1	END CLIP
2	1	5/16-18 X 5/8" HHCS
3	1	5/16 NUT

NOTES:

1. XX = FINISH CODE; STANDARD FINISH, XX = 30.

ORDERING NUMBER: 00303900XX

MAIN FRAME END CLIP, HORIZONTAL SIDE

FIG. 003039

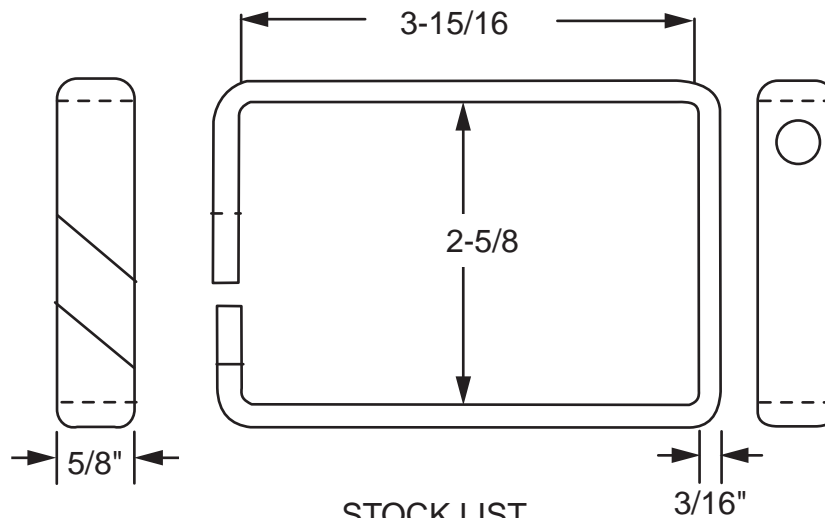

STOCK LIST

ITEM	QTY.	DESCRIPTION
1	1	CABLE BRACKET
2	1	5/16-18 X 7/8" HHCS
3	1	5/16 HEX NUT

NOTES:

1. XX = FINISH CODE; STANDARD FINISH, XX = 30.

ORDERING NUMBER: 00304100XX

CABLE BRACKET

FIG. 003041

ORDERING TABLE

ITEM	ORDERING NO.
1	0030420111
2	0030420211
3	0030420311

NOTES:

1. FINISH IS ZINC PLATED AND CLEAR CHROMATE.

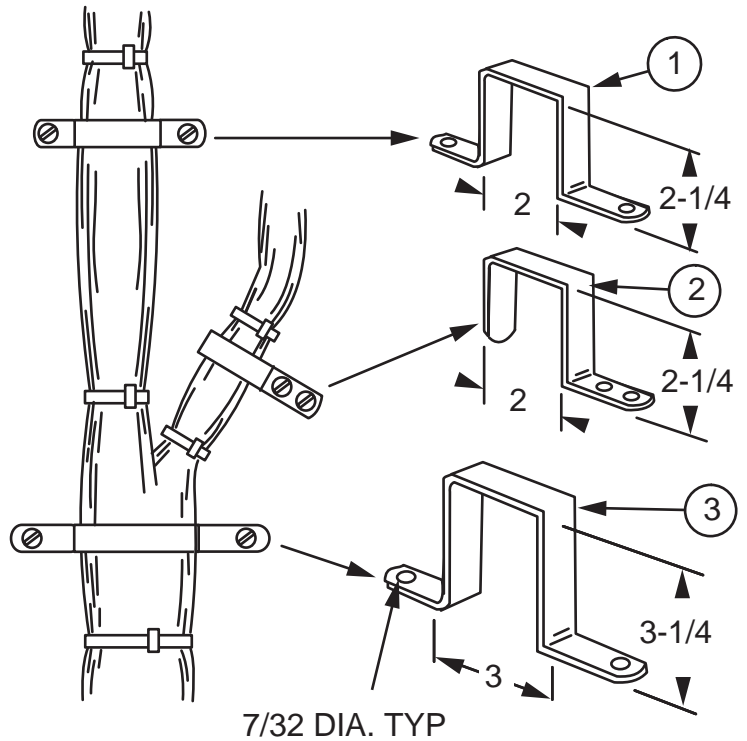

ORDERING NUMBER: REFER TO TABLE

FIG. 003042

CABLE DISTRIBUTION RINGS

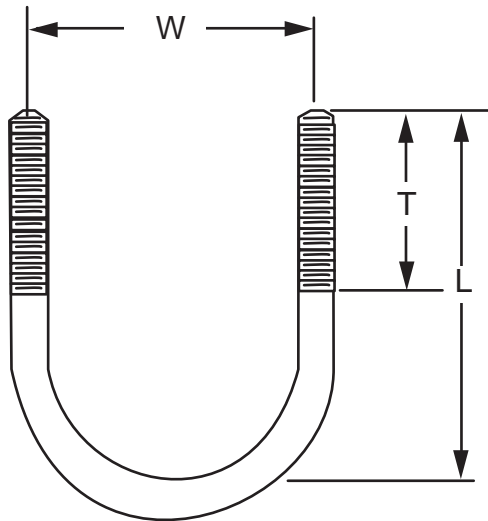

NOTES:

1. FINISH IS ZINC PLATED AND GOLD CHROMATE.

ORDERING TABLE

ORDERING NO.	L	T	W	THREAD
0030430110	2-3/8	1-3/4	1-1/8	1/4-20
0030430210	2-5/8	1-3/4	1-3/8	1/4-20
0030430310	2-7/8	1-3/4	1-5/8	1/4-20

ORDERING NUMBER: REFER TO TABLE

FIG. 003043

U-BOLT

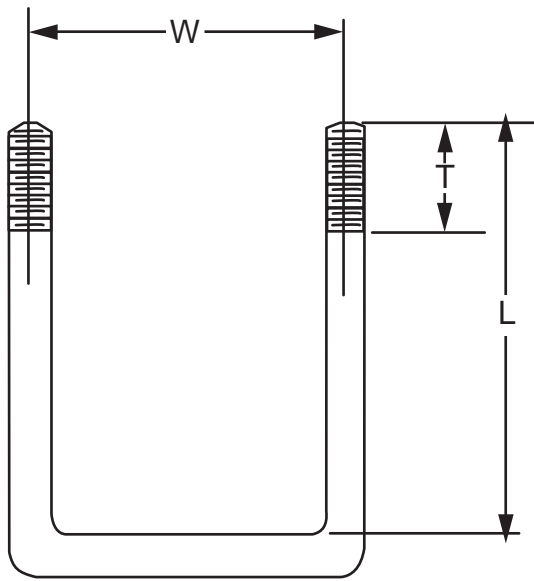

ORDERING TABLE

ORDERING NO.	L	T	W	THREAD
0030440110	2-3/8	1	1-31/32	5/16-18
0030440210	3	1	1-31/32	5/16-18
0030440310	3-15/16	2-1/2	1-15/16	5/16-18
0030440410	4-1/4	1-1/4	2-11/16	5/16-18
0030440510	5-3/4	1-1/4	2-11/16	5/16-18
0030440610	3-1/4	1-1/4	2-3/4	5/16-18
0030440710	2-3/8	1-1/4	2-1/4	5/16-18
0030440810	1-1/4	7/8	1-15/16	5/16-18

NOTES:

1. FINISH IS ZINC PLATED AND GOLD CHROMATE.

ORDERING NUMBER: REFER TO TABLE

U-BOLT, SQUARE BEND

FIG. 003044

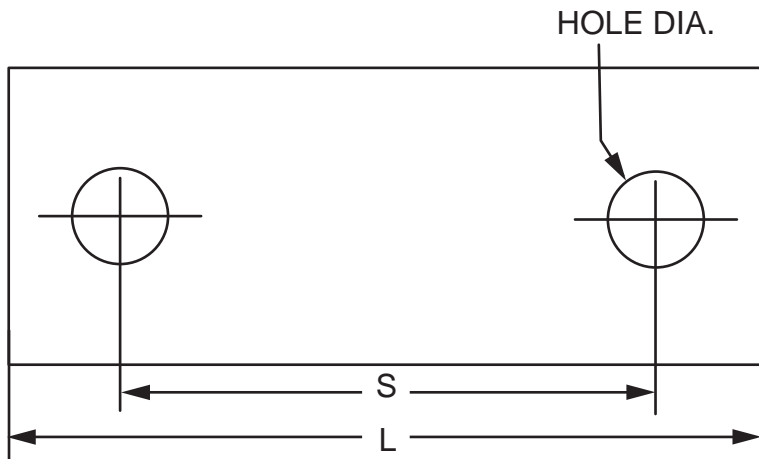

ORDERING TABLE

ORDERING NO.	L	S	HOLE DIA
0030450110	2-1/4	1-1/8	5/16
0030450210	2-1/4	1-3/8	5/16
0030450310	2-3/4	1-5/8	5/16
0030450410	3	1-15/16	3/8
0030450510	3-1/4	2-1/4	3/8
0030450610	3-1/2	2-11/16	3/8
0030450710	3-3/4	2-3/4	3/8
0030450810	3-5/8	2-5/8	3/8

NOTES:

1. FINISH IS ZINC PLATED AND GOLD CHROMATE.

ORDERING NUMBER: REFER TO TABLE

MISCELLANEOUS U-BOLT PLATES

FIG. 003045

ORDERING TABLE

ORDERING NO.	L
00304701XX	8'
00304702XX	10'

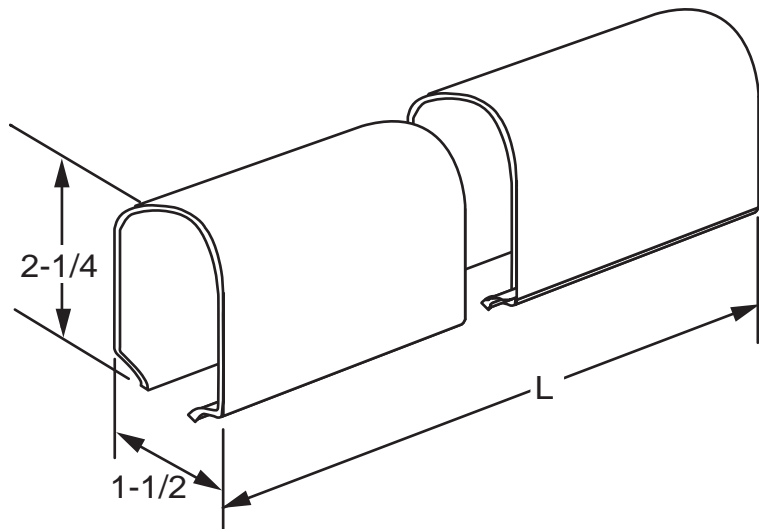

NOTES:

1. XX = FINISH CODE; STANDARD FINISH, XX = 30.

ORDERING NUMBER: REFER TO TABLE

LADDER TRACK

FIG. 003047

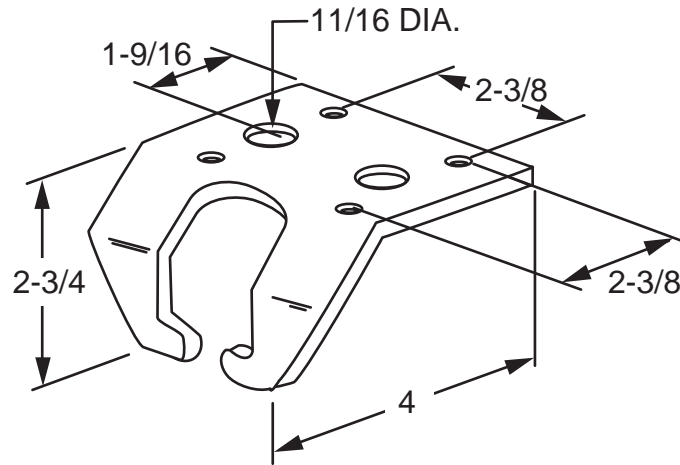

NOTES:

1. XX = FINISH CODE; STANDARD FINISH, XX = 30.

ORDERING NUMBER: 00304800XX

LADDER BRACKET

FIG. 003048

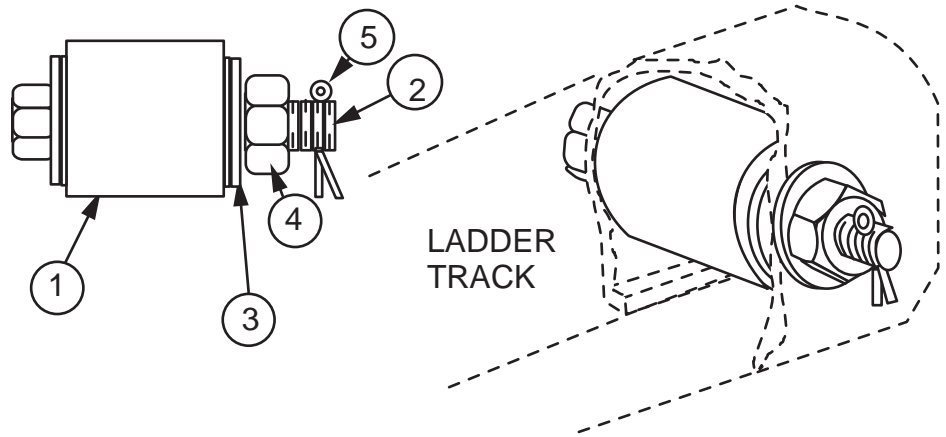

STOCK LIST

ITEM	QTY.	DESCRIPTION
1	1	RUBBER BUSHING
2	1	3/8 HHCS
3	4	FLAT WASHER
4	1	3/8 HEX NUT
5	1	COTTER PIN

NOTES:

1. FINISH IS ZINC PLATED AND CLEAR CHROMATE.

ORDERING NUMBER: 0030490011

LADDER TRACK STOP

FIG. 003049

STOCK LIST

ITEM	QTY.	DESCRIPTION
1	1	SPLICE
2	4	1/4-20 X 1/2 RHMS
3	4	1/4 LOCK WASHER
4	4	1/4 HEX NUT

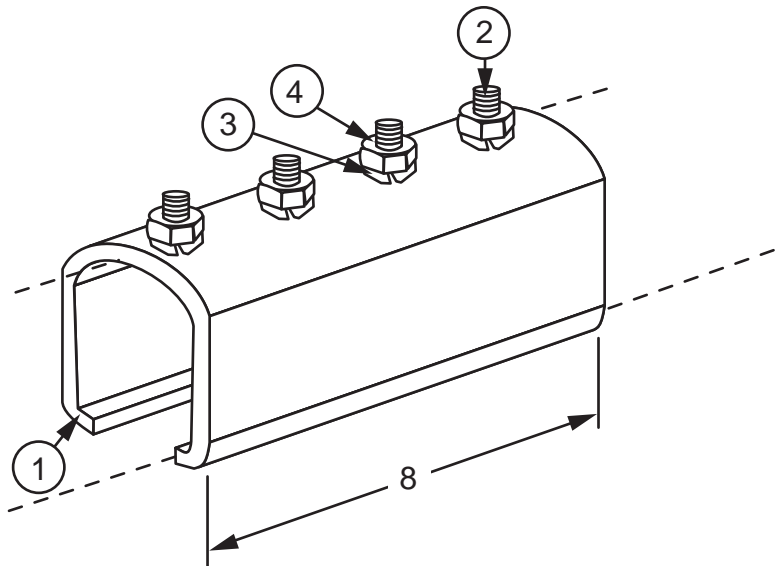

NOTES:

1. FINISH IS ZINC PLATED AND CLEAR CHROMATE.

ORDERING NUMBER: 0030500011

LADDER TRACK SPLICE

FIG. 003050

ORDERING TABLE

ORDERING NO.	DIM A
0030520000	120"
2110120100	72"
2110120200	120"

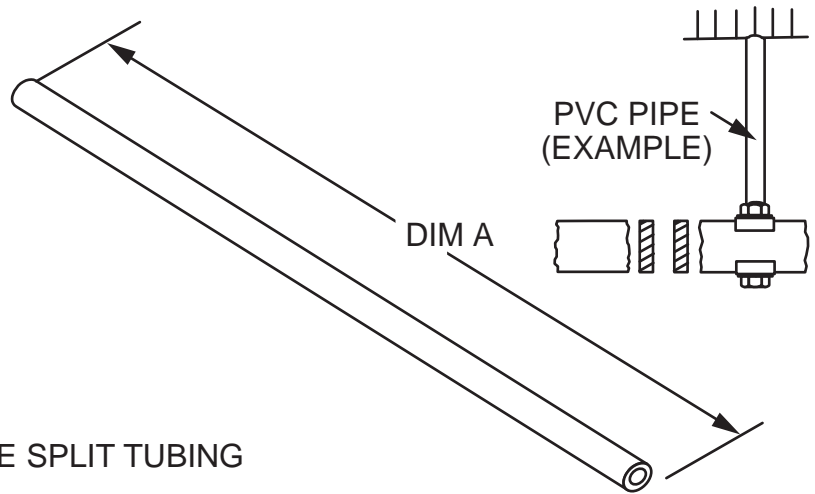

NOTES:

1. STANDARD FINISH IS BLACK.
2. 2110120100 AND 2110120200 ARE SPLIT TUBING APPLICATIONS.

ORDERING NUMBER: 0030520000

PVC PIPE FOR COVERING 5/8" DIA THREADED ROD

FIG. 003052

ORDERING TABLE

ORDERING NO.	THREAD	H	W	PKGD. QTY.
0030530110	3/8-16	1-3/4	5/8	25
0030530210	1/2-13	1-3/4	11/16	25
0030530310	5/8-11	2-1/8	13/16	25

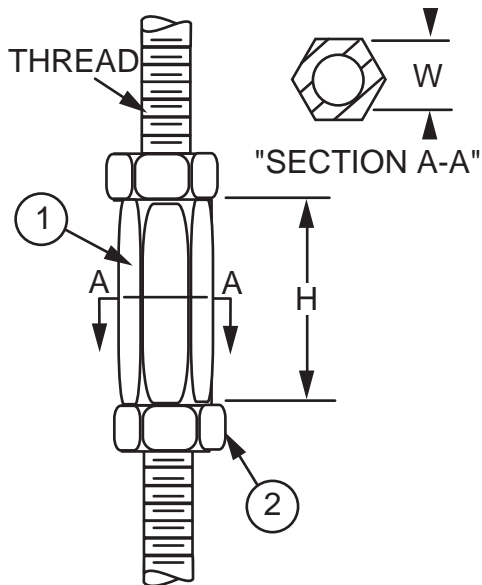

STOCK LIST

ITEM	QTY.	DESCRIPTION
1	1	COUPLING
2	2	HEX NUT

NOTES:

1. FINISH IS ZINC PLATED AND GOLD CHROMATE.

ORDERING NUMBER: 0030530010

THREADED ROD COUPLING

FIG. 003053



ORDERING TABLE

ORDERING NO.	DESCRIPTION	FINISH CODE
0030540100	GRAY 01 (TE GRAY)	30
0030540200	GRAY 02	31
0030540300	BLUE 07	64
0030541000	BROWN 01 (MAPLE)	50

NOTES:

1. AIR DRY ENAMEL.

ORDERING NUMBER: REFER TO TABLE

FIG. 003054

TOUCH-UP PAINT, AEROSOL



ORDERING TABLE

ORDERING NO.	DESCRIPTION	FINISH CODE
00435601XX	BLUE	64
00435602XX	GRAY 02	31
00435603XX	GRAY 01	30
00435604XX	BROWN	50
00435605XX	WHITE	90

NOTES:

1. AIR DRY ENAMEL.
2. BRUSH IS ATTACHED TO CAP.
3. 0.6 OZ. BOTTLE

ORDERING NUMBER: REFER TO TABLE

FIG. 004356

TOUCH UP PAINT

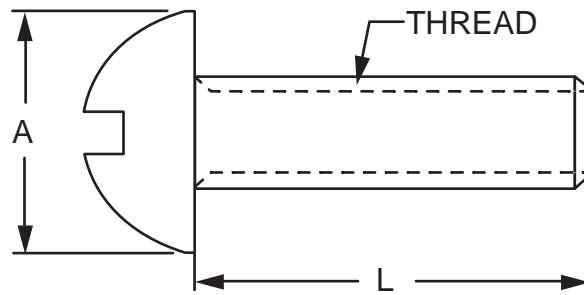

ORDERING TABLE

ORDERING NO.	A	L	THREAD
0030690100	.290	1/2	8-32
0030690200	.290	1	8-32
0030690300	.360	1/2	10-32
0030690400	.360	1	10-32
0030690500	.475	1/2	1/4-20
0030690600	.475	1	1/4-20

ORDERING NUMBER: REFER TO TABLE

NYLON ROUND HEAD SCREW, TYPE 6/6

FIG. 003069

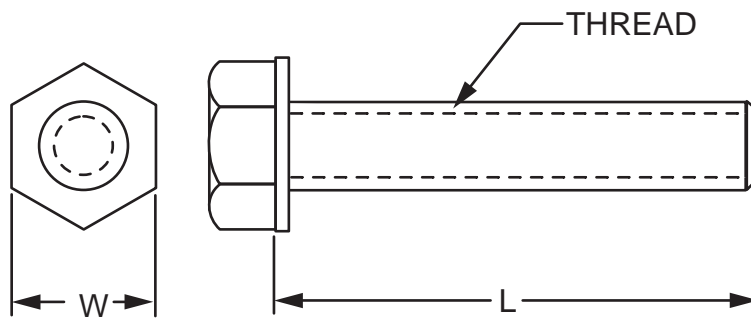

ORDERING TABLE

ORDERING NO.	W	L	THREAD	PKGD. QTY.	ORDERING NO.	W	L	THREAD	PKGD. QTY.
0030700100	.425	1/2	1/4-20	25	0030700700	.740	1	1/2-13	25
0030700200	.425	1	1/4-20	25	0030700800	.740	1-1/2	1/2-13	25
0030700300	.485	1/2	5/16-18	25	0030700900	.935	1	5/8-11	25
0030700400	.485	1	5/16-18	25	0030701000	.935	2	5/8-11	25
0030700500	.656	1	3/8-16	25	0030701100	.425	1-1/2	1/4-20	25
0030700600	.565	1-1/2	3/8-16	25					

ORDERING NUMBER: REFER TO TABLE

NYLON HEX HEAD CAP SCREW (TYPE 6/6)

FIG. 003070

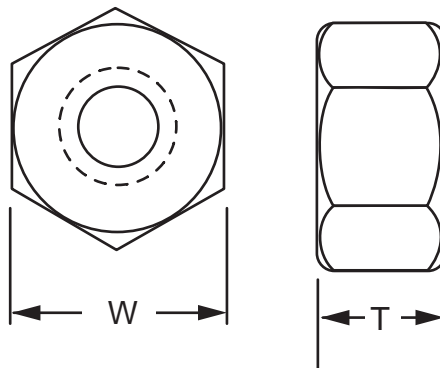

ORDERING TABLE

ORDERING NO.	W	T	THREAD	PACKAGED QTY.
0030710100	.425	.200	1/4-20	100
0030710200	.500	.270	5/16-18	100
0030710300	.560	.330	3/8-16	100
0030710400	.750	.430	1/2-13	50
0030710500	.925	.550	5/8-11	25

ORDERING NUMBER: REFER TO TABLE

NYLON HEX NUT (TYPE 6/6)

FIG. 003071

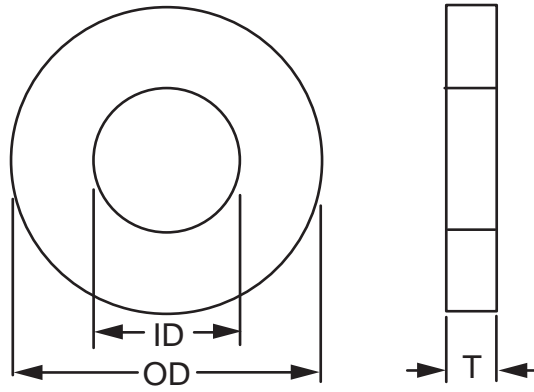

ORDERING TABLE

ORDERING NO.	ID	OD	T	PACKAGED QTY.
0030720100	.257	1/2	.062	50
0030720200	.317	1/2	.062	50
0030720300	.380	5/8	.062	25
0030720400	.505	3/4	.062	25

ORDERING NUMBER: REFER TO TABLE

NYLON FLAT WASHER (TYPE 6/6)

FIG. 003072

ORDERING TABLE

ORDERING NO.	THREAD ROD SIZE
0030740100	3/8-16
0030740200	1/2-13
0030740300	5/8-11
0030740400	3/4-10

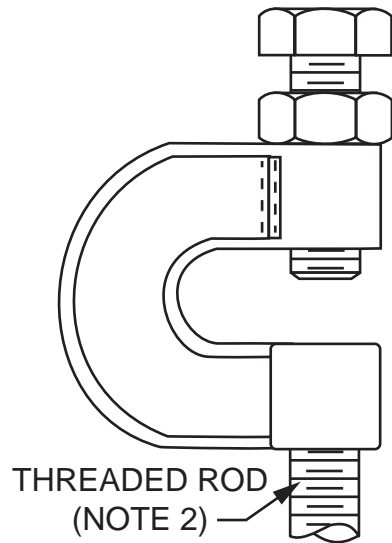

NOTES:

1. FOR ATTACHMENT TO "I" BEAMS, CHANNEL AND ANGLE FLANGE WHERE THE FLANGE THICKNESS DOES NOT EXCEED 3/4".
2. REFER TO FIG. 003020, 003021, OR 003022.

ORDERING NUMBER: REFER TO TABLE

BEAM CLAMP

FIG. 003074

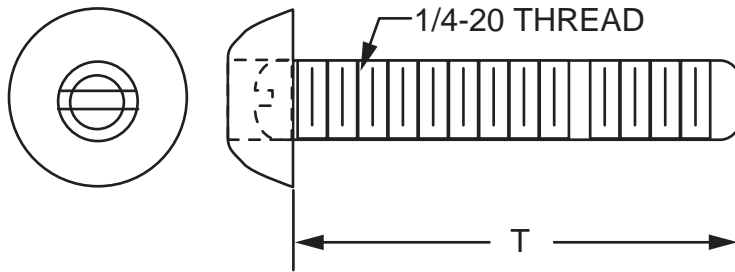

ORDERING TABLE

ORDERING NO.	T	THREAD SIZE
0030750000	3/4	1/4-20
0030750200	1	1/4-20
0030750300	1-1/4	1/4-20
0030750400	1-1/2	1/4-20

ORDERING NUMBER: REFER TO TABLE

NYLON/STEEL CORE PAN HEAD SCREW

FIG. 003075

ORDERING TABLE

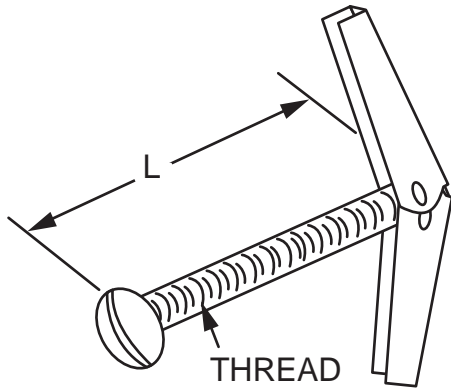

ORDERING NO.	L	THREAD SIZE	PACKAGED QTY.
0030760111	2	10-24	50
0030760211	3	10-24	25
0030760311	4	10-24	10
0030760411	3	1/4-20	25
0030760511	4	1/4-20	10
0030760611	3	5/16-18	25
0030760711	4	5/16-18	10
0030760811	3	3/8-16	25
0030760911	4	3/8-16	10

NOTES:

1. FINISH IS ZINC PLATED AND CLEAR CHROMATE.

ORDERING NUMBER: REFER TO TABLE

TOGGLE BOLT ASSEMBLY

FIG. 003076

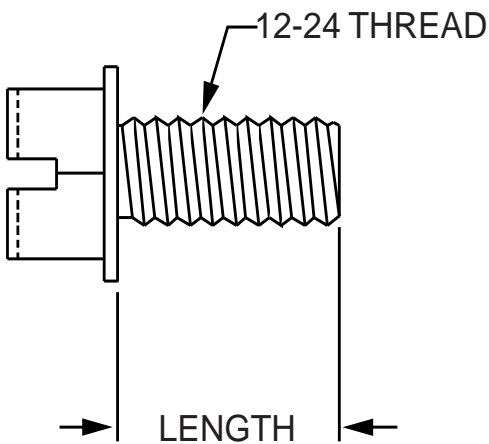

ORDERING TABLE

ORDERING NO.	LENGTH
2108940110	3/8
2108940210	1/2
2108940310	5/8
2108940410	1/4
2108940510	3/4

NOTES:

1. FINISH IS ZINC PLATED AND GOLD CHROMATE.

ORDERING NUMBER: REFER TO TABLE

12-24 THREAD FORMING SCREW

FIG. 210894

ORDERING TABLE

ORDERING NO.	SIZE	PACKAGED QTY.
2080170110	#8	100
2080170210	#10	100
2080170310	#12	100
2080170410	1/4	100
2080170510	5/16	100
2080170610	3/8	100
2080170710	1/2	50
2080170810	5/8	50

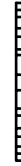
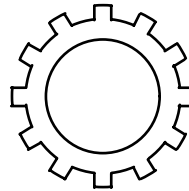

NOTES:

1. FINISH IS ZINC PLATED AND GOLD CHROMATE.

ORDERING NUMBER: REFER TO TABLE

EXTERNAL TOOTH LOCK WASHER

FIG. 208017

ORDERING TABLE

ORDERING NO.	LENGTH
2115810110	4-3/8
2115810210	4-7/8

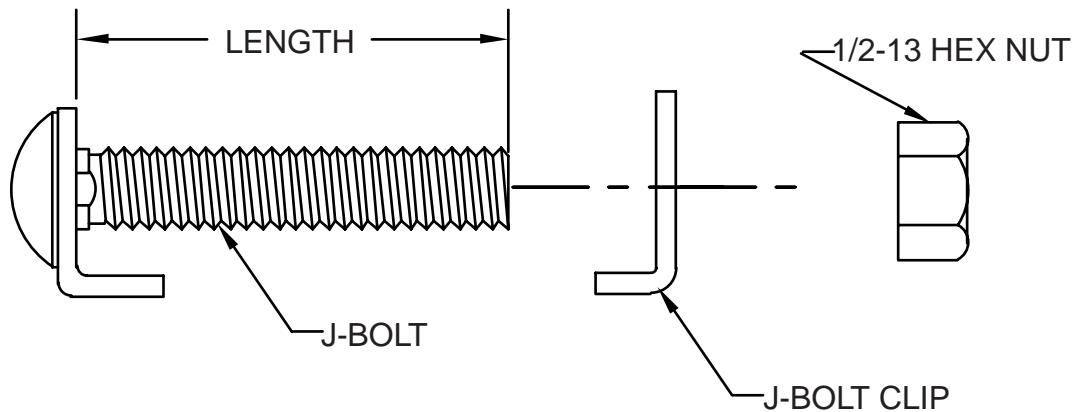

NOTES:

1. FINISH IS ZINC PLATED AND GOLD CHROMATE.

ORDERING NUMBER: REFER TO TABLE

J-BOLT KIT

FIG. 211581